

## FEATURES

- Transitional design with Americana influence
- Enhanced storage with drawers and doors
- Available in Brown Ebony and Whitewash

## COLORS / FINISHES

- DK: Brown Ebony
- WT: Whitewash

## NOMINAL DIMENSIONS

- 18" Width x 26" Height

## SPECIFIED MODEL

MODEL	DESCRIPTION	COLORS / FINISHES
LT-KENT-CGD-18DK / WT	KENT Storage System - Shelf with Mirrored Door	<input type="checkbox"/> Brown Ebony <input type="checkbox"/> Whitewash

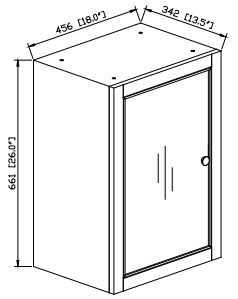

## PRODUCT DIAGRAM

